



STARHOTELS[®]
PREMIUM

Michelangelo
ROMA

Michelangelo

ROMA



The essence of Rome

The Starhotels Michelangelo embodies all the qualities that make Rome unique: cosmopolitan style, classical grandeur and a spellbinding, timeless appeal. It is located in the heart of Rome's Baroque splendour, only a short walk from Castel Sant'Angelo, the Vatican and St Peter's dome.

The 179 newly renovated rooms and suites provide an oasis of calm after a lively day spent exploring the city and many of them offer a magnificent view of the St Peter's dome.

Michelangelo

ROMA

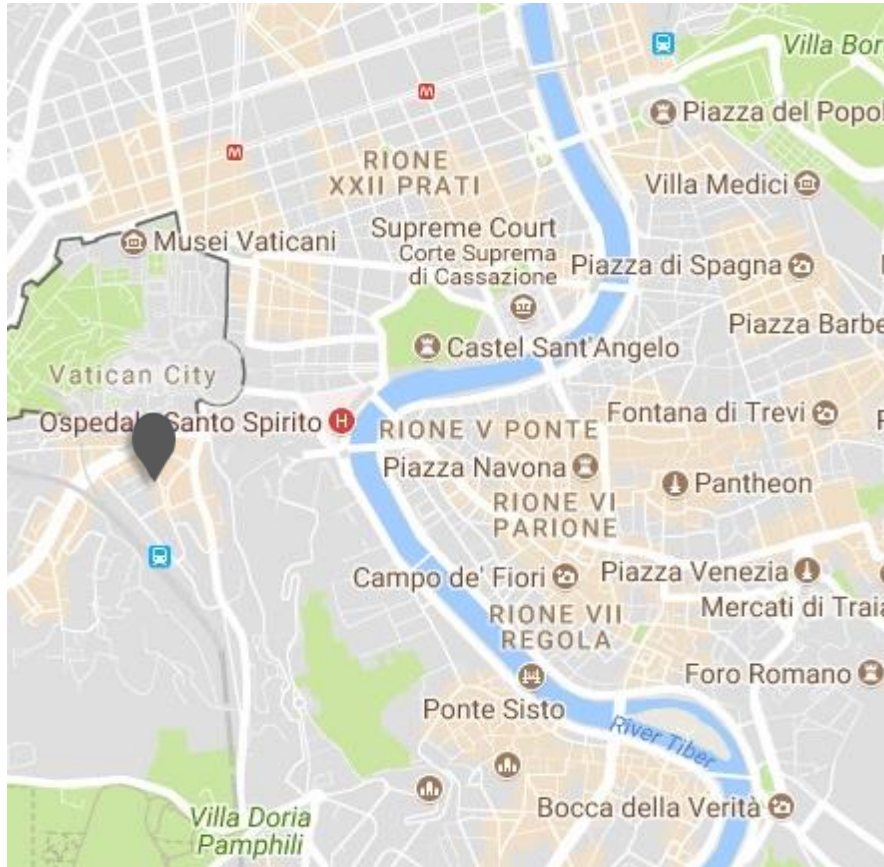

Location

Only a few minutes' walk from Castel Sant'Angelo, the Vatican and St Peter's dome

Distances

Central railway station: Km 6

Highway: Km 10

Airport: Fiumicino Km 30

Via Della Stazione di S. Pietro, 14
00165 Roma - ITALY
T +39 06 398739 F +39 06 632359
michelangelo.rm@starhotels.it
starhotels.com

Michelangelo

ROMA

Restaurant & Bar

Guests can enjoy typical Roman dishes in the intimate, refined setting of The Dome by Eataly restaurant. The imaginative menu features local and international dishes, inspired by the partnership with Eataly.

The discreet, informal atmosphere of the bar is ideal for a break, a quick lunch or a cocktail.



Michelangelo

ROMA



179 Rooms

- 13 Classic
- 67 Superior
- 44 Deluxe
- 45 Deluxe with View
- 4 Junior Suite
- 6 Suite

The 179 elegant rooms and suites, all recently renovated and offering every comfort, are furnished in a classical style, with prestigious red and ochre fabrics as a homage to the Eternal City. Many offer an unforgettable view of St Peter's dome.



Michelangelo

ROMA



Meetings & Events

Meeting rooms: 2

Capacity (theatre style): 140 max

The hotel has 2 meeting rooms, equipped with advanced technology, that can host up to 140 people.



Michelangelo

ROMA

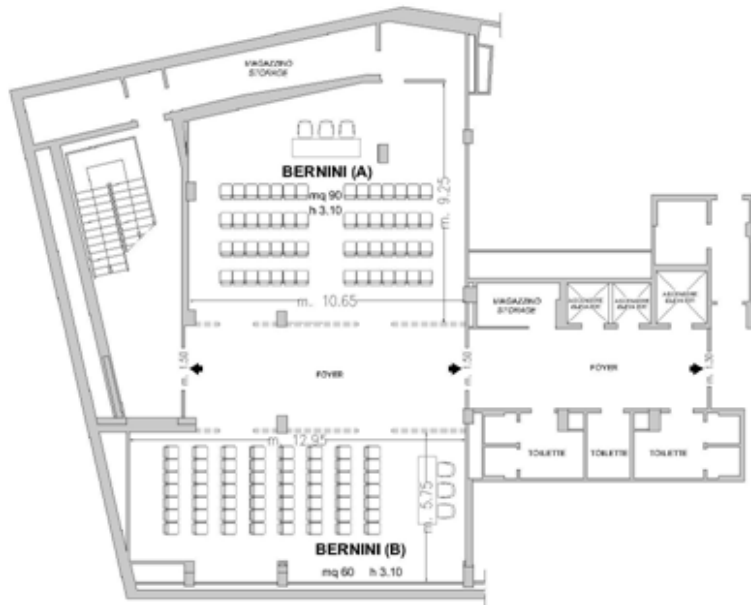

Piano -1 / Basement

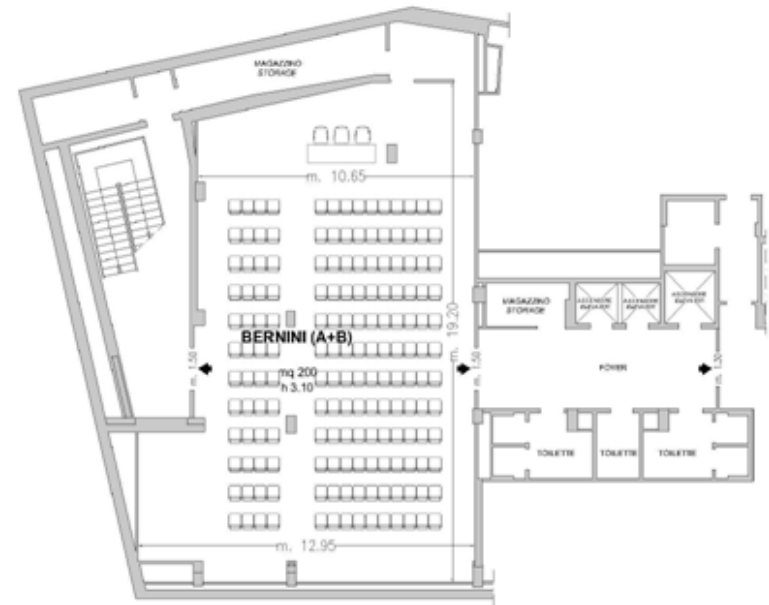

Piano -1 / Basement



Piano Terra / Ground Floor

- ◆ Uscite di sicurezza / Emergency Exits
- Finestre / Windows
- Pareti mobili / Modular Walls
- Colonne / Columns

Michelangelo

ROMA

Meeting rooms	Area mq / ft.	L x W mt. / ft.	Height mt. / ft.	Theatre	Class room	Conference table/ U-shape	Cabaret style [^]	Cocktail reception	Banquet
Bernini (A)	90 968,4	10,56x8,50 34,64x27,87	3 9,83	60	27/30*	20	30***	50	60
Bernini (B)	60 645,6	12,84x4,95 42,11x16,23	3 9,83	55	20/25**	20	18***	40	40
Bernini (A+B)	200 2152	18,40x10,86 60,34x35,61	3 9,83	140	60	40****	54***	120	120
N° 6 Studio °	12 129,17	-	2,95 9,68	-	-	10	-	-	-
The Dome by Eataty Restaurant °	270 2,906	25x7,85 81,99x25,74	2,90 9,51	-	-	-	-	140	140

° Luce Naturale / Daylight

* Max. 30, con 2 banchi uniti - 5 pax per fila - con 1 solo corridoio centrale / 2 connected tables - 5 pax for line - 1 central corridor

** Max. 25, con 2 banchi uniti - 5 pax per fila - no corridoio centrale / Max. 25, 2 connected tables - 5 pax for line - no central corridor

*** Cabaret Style con Tavoli diam. 180 cm. ó pax per tavolo [c/videoproiezione] / Cabaret style, diameter tables cm 180, up to ó pax each [c/videoprojection]

*** La videoproiezione è con schermo mobile sistemato verso gli armadi e con proiettore a terra / Videoprojection with movable screen, towards the armoires, projector on floor